

WILCOX 2-LIGHT VANITY SCONCE

JOB NAME: _____ FIXTURE TYPE: _____

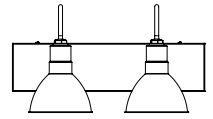

BLE - WVS2 - - - -

A B C D

Order Example: BLE - WVS2 - DBW10 - 710 - WC - 200

A - SHADE SIZE

WILCOX:

DBW8 (2) 8" Shades¹
DBW10 (2) 10" Shades

B - SHADE FINISH

POWDER COAT FINISHES²:

100	Black
105	Textured Black
106	Matte Black
200	White
206	Matte White
300	Dark Green
307	Emerald Green
311	Jadite
370	Mint
380	Chartreuse
390	Teal
400	Barn Red
420	Orange
470	Watermelon
480	Blush Pink
490	Magenta
495	Sherbet Orange
500	Buttery Yellow
570	Sunflower
600	Bronze
601	Chocolate
605	Rust
615	Oil-Rubbed Bronze

B - SHADE FINISH (CONTINUED)

POWDER COAT FINISHES²:

700	Royal Blue
705	Navy
710	Cobalt Blue
715	Delphite Blue
790	Lavender
800	Industrial Grey
805	Charcoal Granite
810	Graphite
975	Galvanized

C - SHADE ACCESSORY

NA	None
WC	(2) Wire Cages
ACR	(2) Acrylic Diffusers ^{3,4}

D - SHADE ACCESSORY FINISH

*Please Note: See **Section B** for all applicable wire cage finish options.
(I) If no wire cage selected in Section C, please select NA.*

NA Not Applicable

IMPORTANT: (1) Not available with Acrylic Diffuser accessory (2) All Powder Coat finished shades, with the exception of 975-Galvanized, feature a white interior (3) Acrylic Diffuser accessory reduces incandescent wattage to 60W (4) Fixture is UL Listed for Damp Locations with Acrylic Diffuser

MOUNTING DIMENSIONS

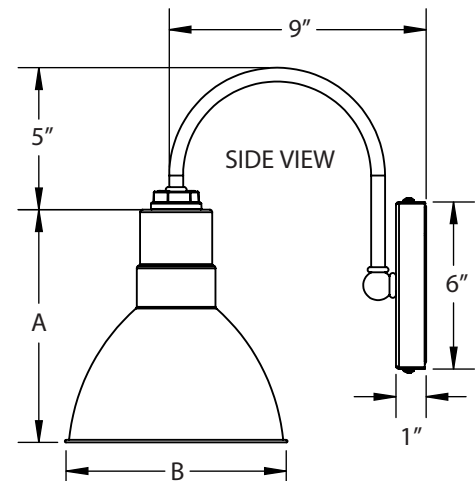
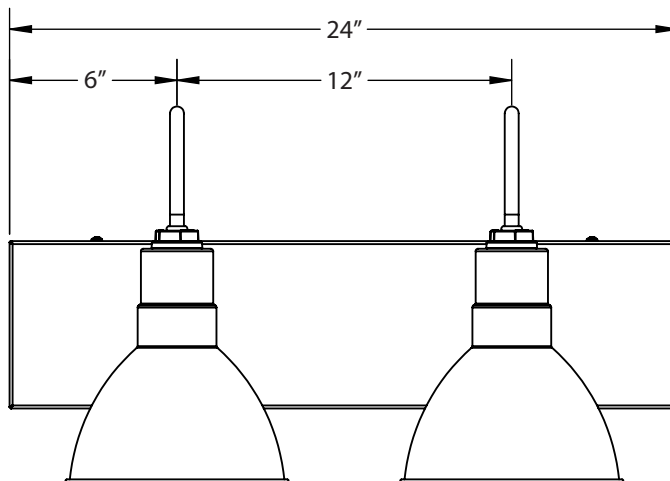

SHADE CODE	HEIGHT (A)	DIAMETER (B)
DBW8	8.4"	8"
DBW10	9"	10"

SPECIFICATIONS

CERTIFICATIONS, LISTINGS & WARRANTY

MADE IN THE USA
Manufactured and Hand-Crafted in Our 60,000 Square Foot Facility
Located in Titusville, FL

CSA LISTED FOR DAMP LOCATIONS
ACR is UL Listed for Damp Locations

LIMITED WARRANTY
For Additional Information on Our Limited Warranty, Please See
Our Terms & Conditions

UL CERTIFICATION
UL Listed Fixtures Available upon Request. Please Consult Factory
for Additonal Information.

CONSTRUCTION & FINISH

POWDER COAT SHADE
Hand-Spun from High Purity 3003-O Temper Aluminum

VANITY PLATE
Constructed from 19 Gauge Galvanized Steel

POWDER COAT FINISHES
Polyester Powder Coat Finishes Are Electro-Statically Applied and
Thermocured

MOUNTING ARM
Brass Electroplated Steel Tube

LIGHT SOURCE

INCANDESCENT
Medium Base E26 Socket, 120 VAC, 100W Max