



# BARN LIGHT ELECTRIC COMPANY®

## INSTALLATION INSTRUCTIONS G19 GOOSENECK FIXTURE

Thank you for purchasing from Barn Light Electric, America's leading manufacturer of hand-crafted shades and exclusive source for porcelain enamel lighting! For questions or concerns about your purchase, please contact us!

INS-0029 REV C (HWK-0020)

### IMPORTANT

Read all instructions before assembly. Installation is to be done by a qualified professional. **For wet locations, junction between the mounting surface and luminaire must be sealed with caulking.**

**CAUTION:** Risk of fire, this product must be installed in accordance with the applicable installation code by a person familiar with the construction and operation of the product and the hazards involved.

### INSTRUCTIONS

1. Disconnect power at the electrical panel before installation.
2. Temporarily set backing plate (A) level and plumb against wall to mark the four hole locations for mounting.
3. Drill four 1/2" holes for the anchors (B) provided.
4. Place socket gasket (C) onto socket (D). Feed socket cord through shade (E), coupler o-ring (F) and coupler (G).
5. Insert socket (D) into the shade (E) and screw on coupler (G) (rotate coupler counter-clockwise). **NOTE: Ensure coupler o-ring (F) is seated in coupler (G) groove.**
6. Feed fixture wires through arm (H) and wall backing plate (A).
7. Thread coupler (G) onto arm (H) until tight. **NOTE: Use pipe joint compound or teflon tape to seal connection.**
8. Use wire nuts (I) to connect power supply to the black wire and neutral wire to the white wire. **NOTE: Wire nuts (I) not included.**
9. Attach ground wire (J) to the junction box (K), green wire or bare wire.
10. Align wall backing plate (A) with the four wall anchors (B) and install lag bolts (L) with the metal washers (M) and nylon washers (N) as shown. Tighten until fixture is flush and secure against wall. Do NOT overtighten. **NOTE: Seal edges of wall backing plate (A) against wall with caulking.**

### ALTERNATE FIXTURES

Although the illustration below includes an RLM shade, these alternative fixtures follow the same installation instructions.

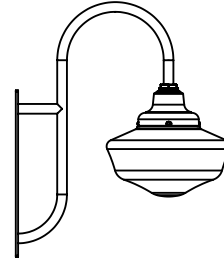

The Academia Schoolhouse  
Gooseneck Light

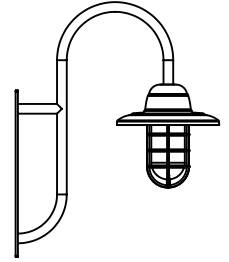

Industrial Guard  
Gooseneck

### WIRING DIAGRAM

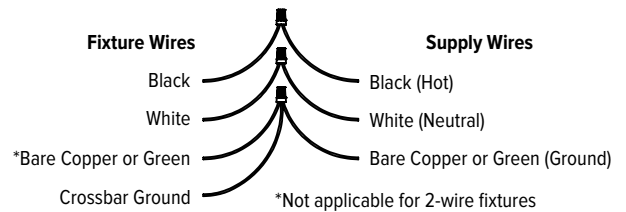

### G19 GOOSENECK FIXTURE

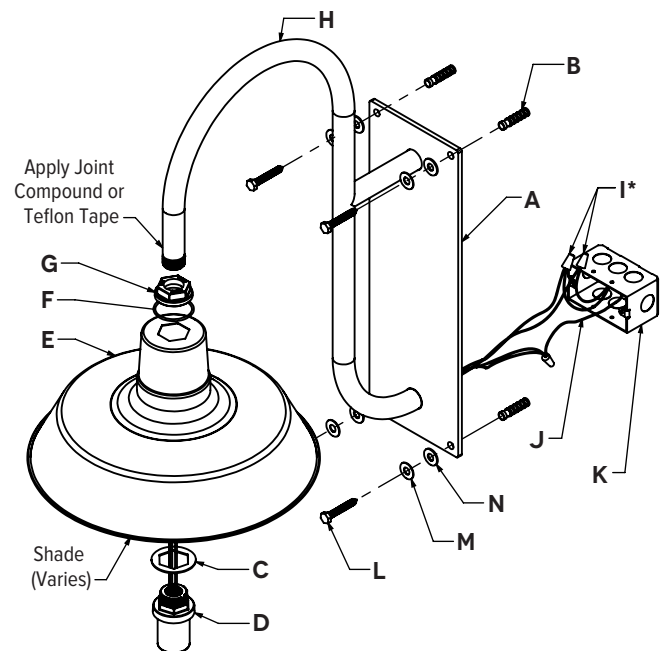

- |                       |                  |
|-----------------------|------------------|
| A. Wall Backing Plate | I. Wire Nuts*    |
| B. Anchors            | J. Ground Wire   |
| C. Socket Gasket      | K. Junction Box  |
| D. Socket             | L. Lag Bolts     |
| E. Shade (Varies)     | M. Metal Washers |
| F. Coupler O-Ring     | N. Nylon Washers |
| G. Coupler            |                  |
| H. Arm (Varies)       |                  |

**\*IMPORTANT:** Wire nuts not included in hardware kit.